



Arctic & North Atlantic Islands 2012



aboard 'Antarctic Dream'

Code	Voyage	Start	End	Nights / Days	Embarkation – Disembarkation	Twin Inside	Twin Porthole	Twin Deluxe	Superior
ATD06 G	North Spitsbergen, <i>Polar Bear Special</i>	JUN 24	JUL 01	07 / 08	Longyearbyen - Longyearbyen	3.150	3.600	4.000	4.450
ATD07	North or Around Spitsbergen	JUL 01	JUL 10	09 / 10	Longyearbyen - Longyearbyen	4.000	4.600	5.150	5.700
ATD08 G	Around Spitsbergen	JUL 10	JUL 19	09 / 10	Longyearbyen - Longyearbyen	4.000	4.600	5.150	5.700
ATD09 G	Around Spitsbergen	JUL 19	JUL 28	09 / 10	Longyearbyen - Longyearbyen	4.000	4.600	5.150	5.700
ATD10	Around Spitsbergen	JUL 28	AUG 06	09 / 10	Longyearbyen - Longyearbyen	4.000	4.600	5.150	5.700
ATD11 H	Around Spitsbergen	AUG 06	AUG 15	09 / 10	Longyearbyen - Longyearbyen	4.000	4.600	5.150	5.700
ATD12	Northeast Greenland	AUG 15	AUG 27	12 / 13	Longyearbyen - Akureyri	5.000	5.700	6.400	7.100
ATD13	Northeast Greenland – North Spitsbergen	AUG 27	SEP 08	12 / 13	Akureyri - Longyearbyen	5.000	5.700	6.400	7.100
ATD14	Scoresby Sund - <i>Aurora Borealis</i>	SEP 08	SEP 17	09 / 10	Longyearbyen - Akureyri	3.550	4.050	4.550	5.050





Arctic & North Atlantic Islands 2012 aboard 'm/v Plancius'



Code	Voyage	Start	End	Nights / Days	Embarkation Disembarkation	Quadruple Porthole	Triple Porthole	Twin Porthole	Twin Window	Twin Deluxe	Superior
PLA04V	Fair Isle - Jan Mayen - Spitsbergen <i>Whale Safari</i>	JUN 07	JUN 18	11 / 12	Vlissingen Longyearbyen	1.650	1.800	2.000	2.100	2.200	2.450
PLA04A	Fair Isle - Jan Mayen - Spitsbergen <i>Whale Safari</i>	JUN 09	JUN 18	09 / 10	Aberdeen Longyearbyen	1.500	1.650	1.800	1.900	2.000	2.250
PLA05 D K S	North Spitsbergen	JUN 18	JUN 25	07 / 08	Longyearbyen Longyearbyen	2.800	3.200	3.600	3.750	4.000	4.450
PLA06 DKPST	North Spitsbergen, <i>Basecamp</i>	JUN 25	JUL 04	09 / 10	Longyearbyen Longyearbyen	3.550	4.050	4.600	4.800	5.150	5.700
PLA07 D	Around Spitsbergen	JUL 04	JUL 13	09 / 10	Longyearbyen Longyearbyen	3.550	4.050	4.600	4.800	5.150	5.700
PLA08	Around Spitsbergen	JUL 13	JUL 22	09 / 10	Longyearbyen Longyearbyen	3.550	4.050	4.600	4.800	5.150	5.700
PLA09	Around Spitsbergen	JUL 22	JUL 31	09 / 10	Longyearbyen Longyearbyen	3.550	4.050	4.600	4.800	5.150	5.700
PLA10 G	Around Spitsbergen	JUL 31	AUG 09	09 / 10	Longyearbyen Longyearbyen	3.550	4.050	4.600	4.800	5.150	5.700
PLA11 B K	Around Spitsbergen - <i>Kvitøya</i>	AUG 09	AUG 19	10 / 11	Longyearbyen Longyearbyen	3.900	4.500	5.100	5.300	5.700	6.300
PLA12	North Spitsbergen, <i>Polar Bear Special</i>	AUG 19	AUG 26	07 / 08	Longyearbyen Longyearbyen	2.800	3.200	3.600	3.750	4.000	4.450
PLA13 B K P	Northeast Greenland	AUG 26	SEP 07	12 / 13	Longyearbyen Akureyri	4.450	5.050	5.700	5.950	6.400	7.100



Dates & Rates 2012 - Arctic & North Atlantic Islands. version: 08 September, 2011. © Oceanwide Expeditions

On all our transactions the general terms and conditions of Oceanwide Expeditions b.v. apply, registered at the Chamber of Commerce, Middelburg, the Netherlands. File nr.: 992249. Upon request, a free copy will be provided.



Arctic & North Atlantic Islands 2012 aboard 'm/v Ortelius'



Code	Voyage	Start	End	Nights/ Days	Embarkation - Disembarkation	Quadruple Non private	Twin non private	Twin Porthole	Twin Window	Superior	Suite
OTL05V	Fair Isle - Jan Mayen – Spitsbergen <i>Whale Safari</i>	JUN 15	JUN 26	11 / 12	Vlissingen - Longyearbyen	1.450	1.700	2.000	2.100	2.450	2.750
OTL05A	Fair Isle - Jan Mayen – Spitsbergen <i>Whale Safari</i>	JUN 17	JUN 26	09 / 10	Aberdeen - Longyearbyen	1.300	1.550	1.800	1.900	2.250	2.500
OTL06	North Spitsbergen <i>Bears and Whales Special</i>	JUN 26	JUL 03	07 / 08	Longyearbyen – Longyearbyen	2.600	3.100	3.600	3.750	4.450	5.000
OTL07	North Spitsbergen <i>Bears and Whales Special</i>	JUL03	JUL 12	09 / 10	Longyearbyen – Longyearbyen	3.350	3.950	4.600	4.800	5.700	6.350
OTL08	Around Spitsbergen	JUL 12	JUL 21	09 / 10	Longyearbyen – Longyearbyen	3.350	3.950	4.600	4.800	5.700	6.350
OTL09	Around Spitsbergen	JUL 21	JUL 30	09 / 10	Longyearbyen – Longyearbyen	3.350	3.950	4.600	4.800	5.700	6.350
OTL10	Around Spitsbergen - Bear Island	JUL 30	AUG 09	10 / 11	Longyearbyen - Kirkenes	3.450	4.050	4.700	4.900	5.800	6.450
OTL11	Franz Josef Land	AUG 09	AUG 21	12 / 13	Kirkenes - Murmansk / Kirkenes	5.050	5.900	6.900	7.150	8.600	9.400
OTL12	Franz Josef Land	AUG 21	SEP 01	11 / 12	Kirkenes / Murmansk - Murmansk / Kirkenes	4.600	5.400	6.300	6.550	7.850	8.650



Dates & Rates 2012 - Arctic & North Atlantic Islands. version: 08 September, 2011. © Oceanwide Expeditions

On all our transactions the general terms and conditions of Oceanwide Expeditions b.v. apply, registered at the Chamber of Commerce, Middelburg, the Netherlands. File nr.: 992249. Upon request, a free copy will be provided.



Arctic & North Atlantic Islands 2012 aboard 's/v Noorderlicht'



Code	Voyage	Start	End	Nights / Days	Embarkation – Disembarkation	Twin Shared Inside
NOO05	North Spitsbergen	JUN 10	JUN 21	11 / 12	Longyearbyen - Longyearbyen	3.150
NOO06	North Spitsbergen	JUN 21	JUL 02	11 / 12	Longyearbyen - Longyearbyen	3.150
NOO07	North Spitsbergen	JUL 02	JUL 13	11 / 12	Longyearbyen - Longyearbyen	3.150
NOO08	Around Spitsbergen	JUL 13	JUL 28	15 / 16	Longyearbyen - Longyearbyen	4.150
NOO09	Around Spitsbergen	JUL 28	AUG 12	15 / 16	Longyearbyen - Longyearbyen	4.150
NOO10	Around Spitsbergen	AUG 12	AUG 27	15 / 16	Longyearbyen - Longyearbyen	4.150
NOO11	Around Spitsbergen	AUG 27	SEP 11	15 / 16	Longyearbyen - Longyearbyen	4.150
NOO12	North Spitsbergen	SEP 11	SEP 21	10 / 11	Longyearbyen - Longyearbyen	2.850
NOO13	South Spitsbergen - <i>Aurora Borealis</i>	SEP 21	SEP 28	07 / 08	Longyearbyen - Longyearbyen	1.760
NOO14	North Spitsbergen - <i>Aurora Borealis</i>	SEP 28	OCT 05	07 / 08	Longyearbyen - Longyearbyen	1.760
NOO15	South Spitsbergen - <i>Aurora Borealis</i>	OCT 05	OCT 12	07 / 08	Longyearbyen - Longyearbyen	1.760
NOO16	West Spitsbergen - <i>Aurora Borealis</i>	OCT 12	OCT 17	05 / 06	Longyearbyen - Longyearbyen	1.260
NOO17	West Spitsbergen - <i>Aurora Borealis</i>	OCT 17	OCT 22	05 / 06	Longyearbyen - Longyearbyen	1.260
NOO20	Lofoten - <i>Aurora Borealis</i>	NOV 08	NOV 15	07 / 08	Lødingen - Lødingen	1.450
NOO21	Lofoten - <i>Aurora Borealis</i>	NOV 15	NOV 22	07 / 08	Lødingen - Lødingen	1.450





Arctic & North Atlantic Islands 2012 aboard 's/v Rembrandt van Rijn'



Code	Voyage	Start	End	Nights / Days	Embarkation – Disembarkation	Twin Shared Porthole	Twin Private Inside	Twin Private Porthole
RVR03	Scottish Islands	May 05	May 12	07 / 08	Aberdeen – Oban	1.650	1.850	2.050
RVR05 S	West Greenland – <i>Whale Safari</i>	MAY 24	MAY 31	07 / 08	Nuuk - Ilulissat	1.300	1.450	1.600
RVR06	Disko Bay – <i>Whale Safari</i>	MAY 31	JUN 07	07 / 08	Ilulissat - Ilulissat	1.850	2.050	2.250
RVR07	Disko Bay – <i>Whale Safari</i>	JUN 07	JUN 14	07 / 08	Ilulissat - Ilulissat	1.850	2.050	2.250
RVR08	Disko Bay – <i>Whale Safari</i>	JUN 14	JUN 21	07 / 08	Ilulissat - Ilulissat	1.850	2.050	2.250
RVR09	Disko Bay – Umanak	JUN 21	JUL 02	11 / 12	Ilulissat - Ilulissat	2.900	3.200	3.500
RVR10	Disko Bay – Umanak	JUL 02	JUL 13	11 / 12	Ilulissat - Ilulissat	2.900	3.200	3.500
RVR11 G	Disko Bay – Upernavik, <i>Drygalski, Wegener</i>	JUL 13	JUL 23	10 / 11	Ilulissat - Upernavik	2.650	2.900	3.150
RVR12 G	North Greenland, <i>Ultima Thule</i>	JUL 23	AUG 07	15 / 16	Upernavik - Upernavik	3.950	4.350	4.800
RVR13A	North Greenland – Cape York	AUG 07	AUG 15	08 / 09	Upernavik - Upernavik	2.100	2.350	2.600
RVR13B	North Greenland – Melville Bay	AUG 15	AUG 22	07 / 08	Upernavik – Upernavik	1.850	2.050	2.250
RVR14	North Greenland, <i>Ultima Thule</i>	AUG 22	SEP 06	15 / 16	Upernavik - Upernavik	3.950	4.350	4.800
RVR15	North Greenland – Umanak	SEP 06	SEP 21	15 / 16	Upernavik - Ilulissat	2.960	3.260	3.600
RVR16	West Greenland – <i>Aurora Borealis</i>	SEP 21	OCT 03	12 / 13	Ilulissat - Narsarsuaq	2.250	2.500	2.750

For reservations please contact:

Oceanwide Expeditions – Head Office

Bellamy park 9
4381 CG Vlissingen
The Netherlands

T +31 (0) 118 410 410

F +31 (0) 118 410 417

E info@oceanwide-expeditions.com

W www.oceanwide-expeditions.com



Dates & Rates 2012 - Arctic & North Atlantic Islands. version: 08 September, 2011. © Oceanwide Expeditions

On all our transactions the general terms and conditions of Oceanwide Expeditions b.v. apply, registered at the Chamber of Commerce, Middelburg, the Netherlands. File nr.: 992249. Upon request, a free copy will be provided.



Arctic & North Atlantic Islands 2012



LEGEND

Icon	Explanation	Surcharge / Supplement
A	Departure from Aberdeen.	-
B	Bilingual: English – German. Bilingual: English – French on PLA11.	-
D	Diving. Group size: min. 8, max. 24 divers.	EUR 300 p.p.
G	German speaking.	-
H	Hikes of approx. 5-7 hours.	-
K	Kayaking. Group size min. 4 – max. 14 kayakers. Kayaking is free of charge on voyage PLA06 “Basecamp Plancius”.	EUR 250 p.p.
P	Photo workshop. Group size: min. 5 – max. 14 photographers. Photo workshop is free of charge on PLA06 “Basecamp Plancius”.and PLA12. Photo workshops are powered by Leica Akademie.	EUR 300 p.p.
S	Snowshoe/hiking. The activity incl. the use of snow shoes.	-
T	Trekking (3 days away from the ship, 2 nights in tents). Trekkers carry provisions in their own rucksack (20 kg). Group size min. 6 – max. 15 trekkers.	EUR 250 p.p.
V	Departure from Vlissingen (Netherlands).	-
*	Currently under charter or sold out.	-
Note	Twin Private Inside cabins on the ATD and RVR have no portholes or windows.	

GENERAL NOTES

FUEL SURCHARGE: It is agreed that if fuel prices will exceed US Dollar 90 per Barrel Brent **90 days prior to departure** Oceanwide Expeditions reserves the right to levy a fuel surcharge of EURO 18 per passenger per night, to be paid by the contracting party of Oceanwide Expeditions





Arctic & North Atlantic Islands 2012



All rates are quoted per person in EURO, based on twin occupancy. EURO rates apply for all sales within Europe. 5% Discount will be granted for bookings for one or more consecutive voyages. Please note that all dates & rates are subject to change. All voyages will operate subject to a minimum of 50 participants on Antarctic Dream, 70 participants on Plancius, 24 on Rembrandt, and 14 participants on Noorderlicht.

Single occupancy: All cabin types at 1.7 times the share price

Fares include:

- Voyage aboard the indicated vessel as indicated in the itinerary.
- All meals throughout the voyage aboard the ship including snacks, coffee and tea.
- All shore excursions and activities throughout the voyage by Zodiac.
- Program of lectures by noted naturalists and leadership by experienced expedition staff.
- Free use of rubber boots and snowshoes on Plancius
- **On Spitsbergen voyages:** Transfers and baggage handling between the airport, hotels and ship only for those passengers on the group flights to and from Longyearbyen.
- **On Northeast Greenland voyages:** Transfer and baggage handling between ship in Akureyri and hotels in Reykjavik by coach (5 hours).
- **On Scoresby Sund voyages:** Transfers and baggage handling between Reykjavik hotels and ship in Akureyri by coach (5 hours) and vice versa.
- **On Rembrandt voyages:** Transfers and baggage handling between airport and ship in Greenland harbours on the chartered group flights.
- **On Franz Josef Land voyages:** OTL11 including bus transfer Murmansk – Kirkenes, OTL12 including bus transfers Kirkenes – Murmansk - Kirkenes
- All miscellaneous service taxes and port charges throughout the programme.
- AECO fees and governmental taxes.
- Comprehensive pre-departure material

Not included: Any airfare, whether on scheduled or charter flights; pre- and post land arrangements; transfers to / from the vessel outside Spitsbergen; passport and visa expenses; Government arrival and departure taxes; meals ashore; baggage, cancellation and personal insurance (which is mandatory); excess baggage charges and all items of a personal nature such as laundry, bar, beverage charges and telecommunication charges; and the customary gratuity at the end of the voyages for stewards and other service personnel aboard (guidelines will be provided).



Arctic & North Atlantic Islands 2012

DECKPLAN ANTARCTIC DREAM

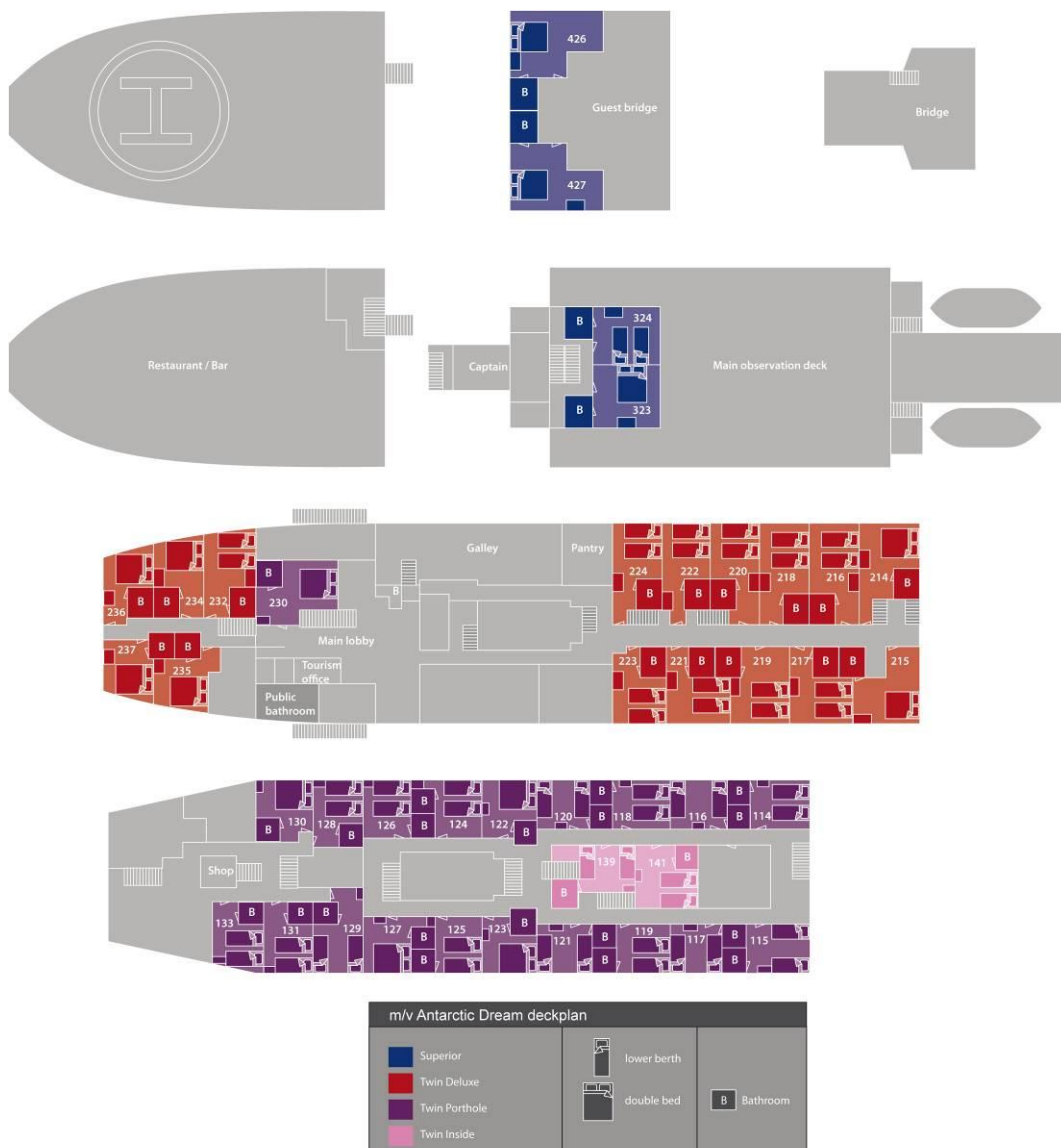

M/v "Antarctic Dream" is a Dutch built ice-reinforced vessel and served under the name Piloto Pardo for the Chilean Navy. The vessel was rebuilt as an unrestricted, worldwide passenger vessel and was completely refurbished in July 2005. M/v "Antarctic Dream" is registered in Panama. The vessel features a spacious dining room / observation lounge, bar, lecture room, fitness room plus sauna, boutique and passenger bridge.

Ship details

- ❖ The vessel offers accommodation for 84 passengers in 42 cabins with private toilet and shower.
- ❖ 4 Superiors, 16 Twin Deluxe cabins and 20 Twin Porthole cabins (with either two separate lower beds or queen beds).
- ❖ 2 Additional Twin Inside cabins (no portholes / windows)
- ❖ All cabins have furthermore a desk, closed circuit TV, and inter-cabin phone service. Satellite email and phone service is available on the bridge.
- ❖ The vessel is manned by 18 well-trained Chilean crew members. The on board staff consists of 1 expedition leader, 4 guides / lecturers, 1 hotel manager, 1 barman, 1 doctor, 4 chefs and 7 waitresses / cabin cleaners.
- ❖ The Antarctic Dream's expeditions offer you the ideal introduction to Spitsbergen and Greenland. Departing from and ending most of the time in the port of Longyearbyen.
- ❖ Our program is geared towards the viewing of wildlife and the breathtaking scenery of narrow waterways, glaciers and icebergs.

Arctic & North Atlantic Islands 2012

DECKPLAN PLANCIUS

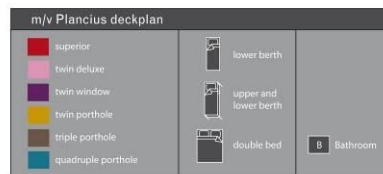
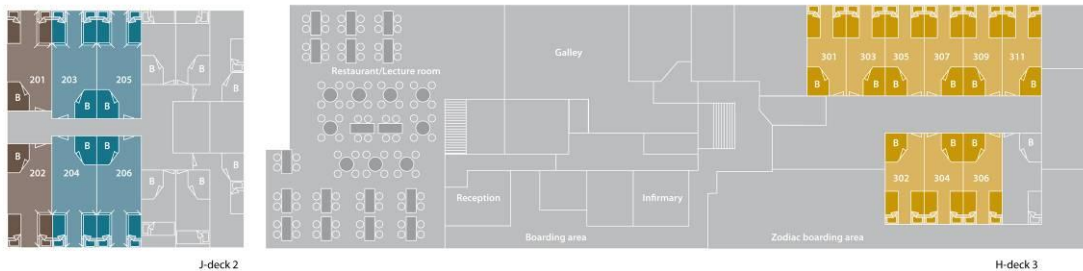
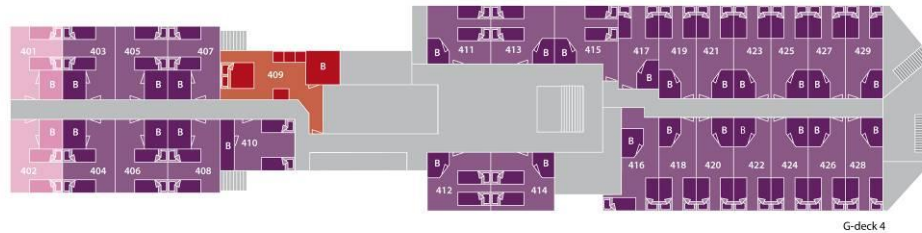
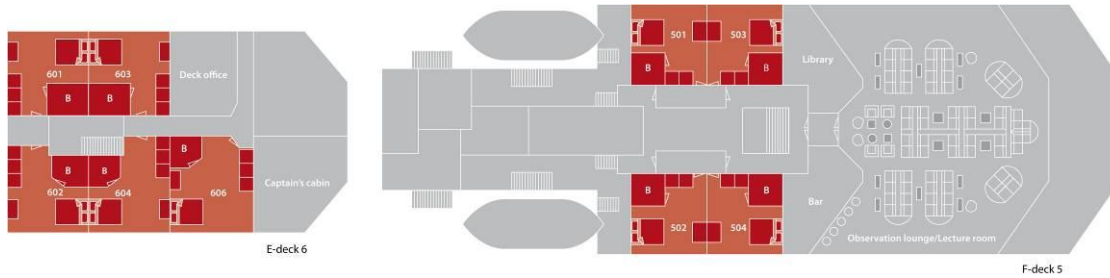

“Plancius” was built in 1976 as an oceanographic research vessel for the Royal Dutch Navy and was named “Hr. Ms. Tydeman”. The ship sailed for the Dutch Navy until June 2004 and was ultimately purchased by Oceanwide Expeditions. “Plancius” is a Dutch flagged completely rebuilt and converted 114-passenger vessel complying with the latest SOLAS- regulations, classed by Lloyd’s Register in London.

“Plancius” is furthermore an homage to Oceanwide Expeditions’ predecessor (Plancius Foundation, 1981-1996), the first cruise operator running on a yearly basis in Spitsbergen, offering voyages with a small cruise vessel named Plancius. It certainly means “the return of Plancius”. Oceanwide continued with the activities of the Plancius Foundation in 1996.

Ship details

- ❖ Comfortable and nicely decorated, but not luxurious. It’s made for explorers
- ❖ Spacious yet small ship character, comfort & style and modern technology
- ❖ Base camp for active, adventure and wildlife minded modern explorers
- ❖ Small ship operation: 114 passengers in 53 passenger cabins with private toilet and shower
- ❖ 4 quadruple porthole cabins, 2 triple porthole cabins, 9 twin porthole cabins, 26 twin cabins with window and 2 twin deluxe cabins, all (ca. 15 m²), 10 superior cabins ca. 21 m²)
- ❖ All cabins offer lower berths (either two single beds or one queen-size bed), except for the 4 quadruple cabins (2 bunk beds), and 2 triple cabins (1 bunk bed plus 1 lower bed)
- ❖ Restaurant/lecture room (deck 3) and a spacious observation lounge (with bar, deck 5) with large windows offer full panorama view
- ❖ Large open deck spaces (with full walk-around possibilities on deck 4), giving excellent opportunities to enjoy the scenery and wildlife
- ❖ Equipped with 10 Mark V inflatable zodiacs, including 40 HP 4-stroke outboard engines
- ❖ 2 gangways on starboard side, guarantee a swift zodiac operation

Plancius – the “base camp” for our activity programme

Oceanwide Expeditions offers an exploratory educational travel programme in the polar regions spending as much time ashore as possible. Special interest activities are available for everyone: Kayaking, Hiking, Snowshoeing, Field Camping, Ski Trekking and Zodiac Cruising. Plancius is equipped with all specialist gear needed to enjoy the outdoor activities: Tents, Sleeping bags, Snowshoes, Kayaks, Rubber boots with grip sole, Outdoor jackets Etc.

Arctic & North Atlantic Islands 2012 DECKPLAN ORTELIUS

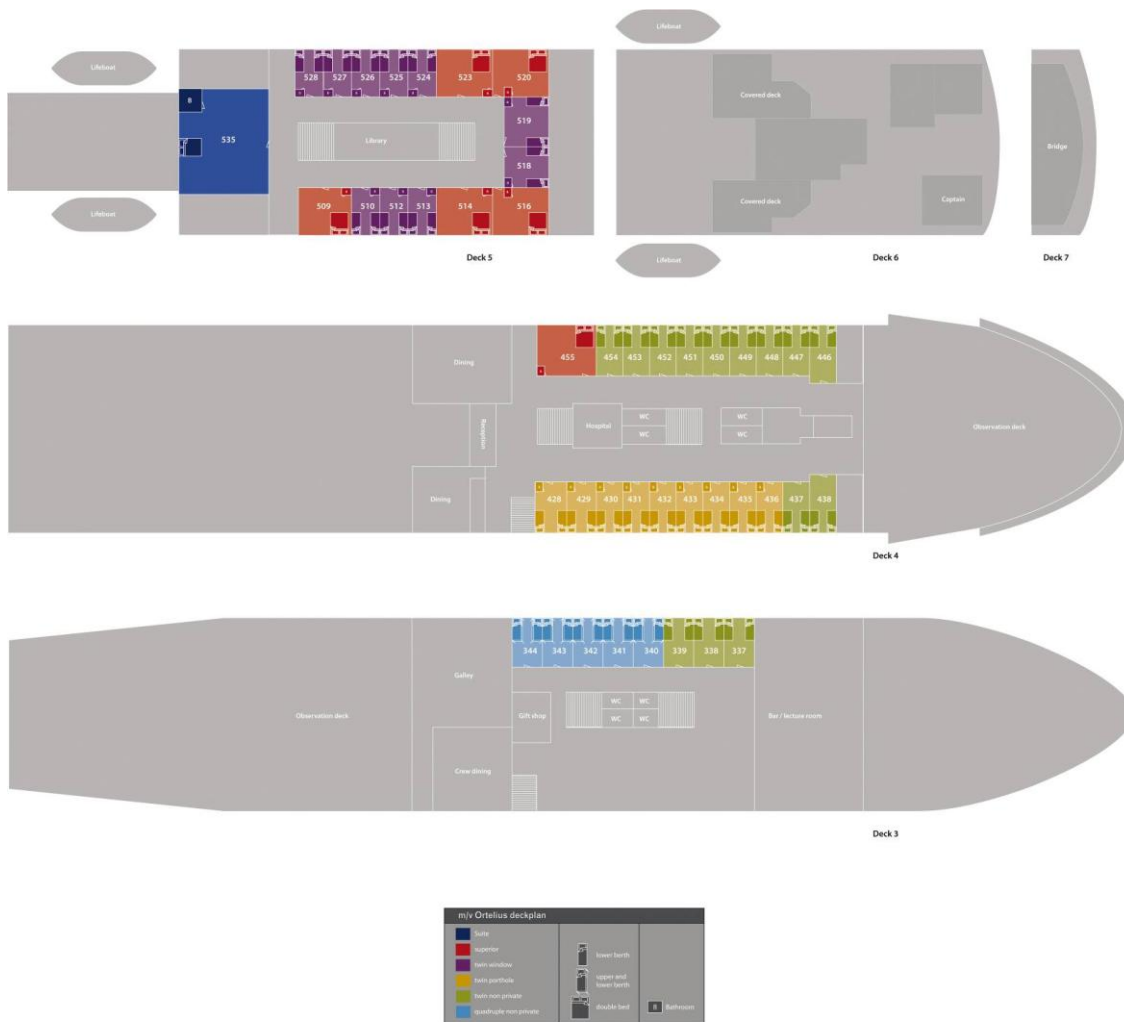

The ice-strengthened vessel “Ortelius” is an excellent vessel for Polar expedition cruises in the Arctic and Antarctica, providing us with possibilities to adventure remote locations such as the Ross Sea and Franz Josef Land.

“Ortelius” was built in Gdynia, Poland in 1989, was named “Marina Svetaeva”, and served as a special purpose vessel for the Russian Academy of Science. The vessel is re-flagged and renamed “Ortelius”. As Plancius, Ortelius was a Dutch / Flemish cartographer. Abraham Ortelius (1527 – 1598) published the first modern world atlas, the *Theatrum Orbis Terrarum* or Theatre of the World in 1570. At that time, the atlas was the most expensive book ever printed.

The vessel has the highest ice-class notation (UL1 equivalent to 1A) and is therefore very suitable to navigate in solid one-year sea ice and loose multi-year pack ice. “Ortelius” is a great expedition vessel for 100 passengers with lots of open-deck spaces and a very large bridge which is accessible to the passengers. The vessel is manned by 34 highly experienced Russian nautical crew, 15 international catering staff, including stewardesses, 6 expedition staff (1 expedition leader and 5 guides/lecturers) and 1 doctor.

A considerable number of quadruple and twin cabins with shared facilities (toilet and showers to be shared in the corridors) offer attractive lower starting prices for our Polar voyages. The vessel offers basic but comfortable cabins and public spaces.

The cabin lay-out is as follows: 5 quadruple cabins with bunk beds and shared facilities (these can also be used as triple or twin cabins); 14 twin cabins with 2 lower single berths and shared facilities; 9 twin cabins with portholes, private toilet and shower and 2 single lower berths; 10 twin cabins with windows, private toilet and shower and 2 single lower berths; 6 superior cabins with double beds, private toilet and shower and a separate day room, and 1 suite with a double bed, private toilet and shower and a separate day room. All cabins are spacious outside cabins with a minimum of two portholes or windows per cabin.

“Ortelius” offers a comfortable hotel standard, with two restaurants, a bar/lecture room and a sauna. Our voyages are primarily developed to offer our passengers a quality exploratory wildlife program, trying to spend as much time ashore as possible. As the number of passengers is limited to approximately 100 on the “Ortelius”, flexibility assures maximum wildlife opportunities.

Arctic & North Atlantic Islands 2012

DECKPLAN NOORDERLICHT

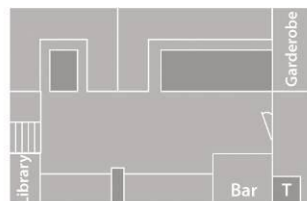

The 'Noorderlicht' was originally built in 1910 in Flensburg, Germany as a three-masted schooner. For most of her existence she served as a light-vessel on the Baltic. In 1991 the present owners purchased the hull and re-rigged and refitted her thoroughly, under the rules of "Register Holland".

The 'Noorderlicht' now has a well-balanced two-masted schooner rig and is capable of sailing the seven seas.

The qualified captains have a great experience of the oceans. Together with the rest of the crew, they will do everything possible to ensure that you have a wonderful and unforgettable journey.

Ice class: The Noorderlicht has no ice class. She was anchored year around near Flensburg (Germany).

Due to heavy ice conditions in the winter time, the bow of the Noorderlicht was strengthened. The vessel is not an ice breaker but has a strengthened bow.

Ship details

The 'Noorderlicht' provides accommodation for 20 travelers in comfortable twin shared inside cabins. All cabins have upper and lower berths, a cupboard and wash basin with hot and cold water. Shared shower (4) and toilet (5) facilities are conveniently located. Instead of portholes, the cabins have frosted glass in the ceiling, where the play of daylight shines into the cabins.

Arctic & North Atlantic Islands 2012 DECKPLAN REMBRANDT VAN RIJN



S/V 'Rembrandt Van Rijn' was built as a herring lugger early last century. The vessel was rebuilt as a three-masted passenger sailing schooner in The Netherlands in 1994 and sailed in Spitsbergen (1994 – 1996) and in Galápagos (1998 - 2001). The vessel underwent a complete rebuilding and refurbishment program in 2011. The communication and navigation equipment has been completely renewed according to the latest SOLAS regulations.

Ship details

- ❖ The Rembrandt van Rijn measures 56 meters in length (168 ft.), 7 meters in width and has a draft of 2,5 meters. The maximum engine speed is 9 knots.
- ❖ She has an experienced crew of 10 on board including two tour guides.
- ❖ The ship can accommodate a maximum of 34 passengers in 17 twin cabins
 - (1 Twin Shared cabin with porthole (shared shower and toilet), 6 Twin Private Inside cabins (with shower and toilet, no porthole), 10 Twin Private cabins (with shower and toilet and porthole).
- ❖ A spacious restaurant on board the vessel allows all passengers to have their meals at the same time. The vessel furthermore consists of a separate bar including a reading table.
- ❖ The ship is well suited for expedition cruising among small islands and offers good open deck viewing areas, even when under sail. The two inflatable rubber crafts (zodiacs) enable landing and wildlife viewing opportunities in otherwise inaccessible areas.

